



ORBITA TECHNOLOGY CO.,LTD

Add:Orbita Industrial Park, Changbu Village, Xinxu Town,
Huiyang Distric, Huizhou City, Guangdong Province, China
Tel:86-752-3633501 Fax:86-752-3633600
Mail:sales@orbitatech.com
Mobile:86-18928480199
Website: www.orbitatech.com
www.orbitalock.com



ISO 9001:2008

CE FC



V.2016

COMPANY PROFILE

Orbita is a reputable hospitality products manufacturer with ISO certified 46,000 square meters garden factory, established to offer the best quality products with professional and effective service to our customers.

Orbita series of products including hotel card locking system, hotel in room safe, hotel minibar, touch screen switch, hotel in room telephone, cabinet locker, smart hotel room system and other hotel in room accessories, are products of years of experience integrated with advanced technologies from Siemens, Dallas, Atmel, Philips etc. Orbita locking system certified by Opera Fidelio and other popular PMS system, has just enabled Orbita products to a wide range of compatibility.

In fact, all of ORBITA products are CE, FCC, RoHS marked and ORBITA is one of the few brands in this industry that passed 800,000 times BHMA standard circling test. Regional standard like SASO, SONCAP, SIRIM are also available with all Orbita products.

More than 10,000 hotels, service apartments, resorts, university dormitories, hospitals and cruise ships covering 100 countries in the world are using Orbita card locks, digital safes, minibars, touch screen switches and other satisfactory hotel intelligent accessories. Our customers include most popular international hotel management groups such as Accor, Marriot, Carlson, Hilton, Starwood, Intercontinental, Kempinski, Crow Regency and other regional hotel management groups. Moreover, Orbita is also offering OEM & ODM services for many leading Europe and American brands in this industry.

ORBITA believes that every customer is a customer for life, manufacturing products of fine quality with our experience and knowledge is our source of pride and customer's satisfaction is our only criterion in service.

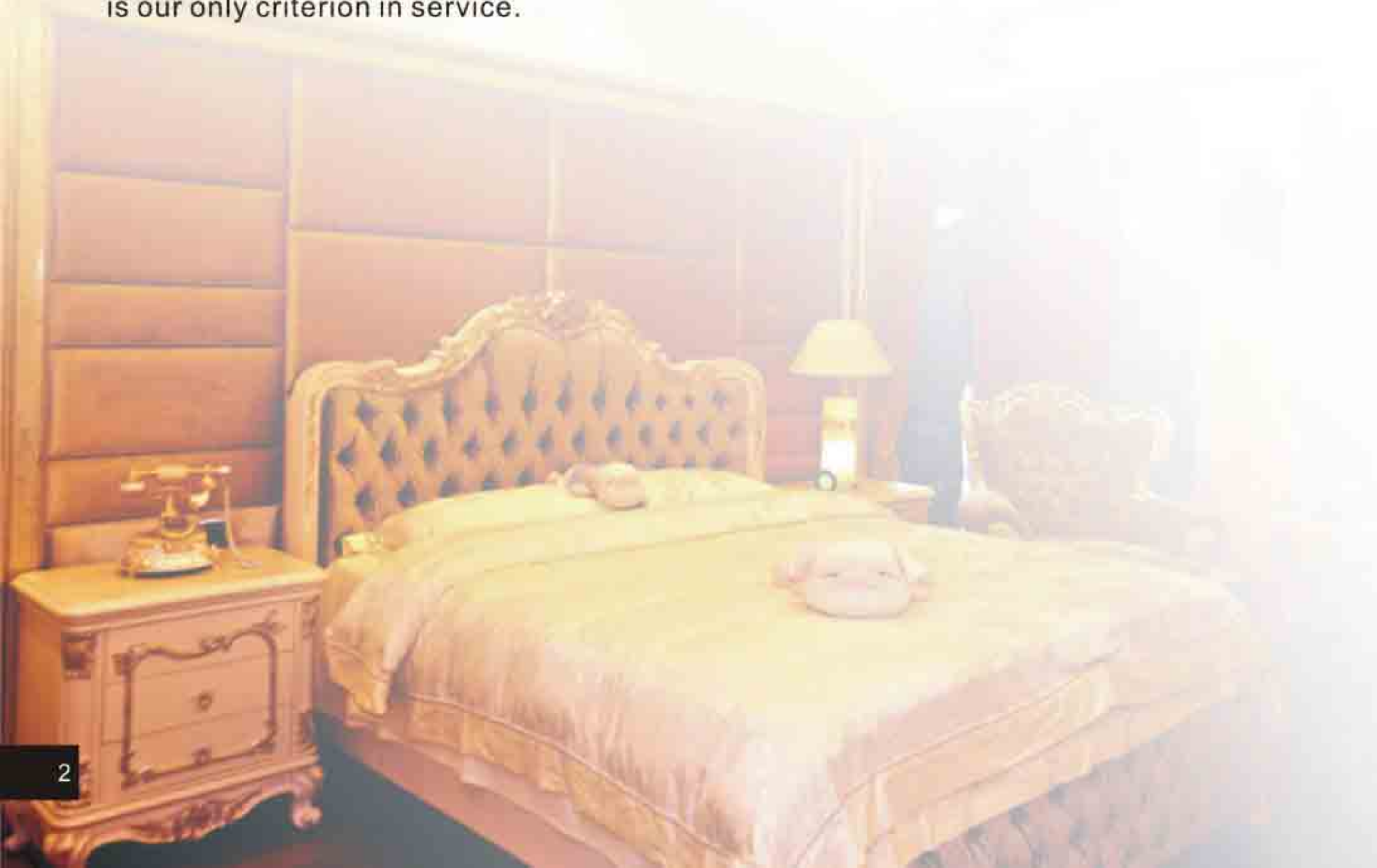
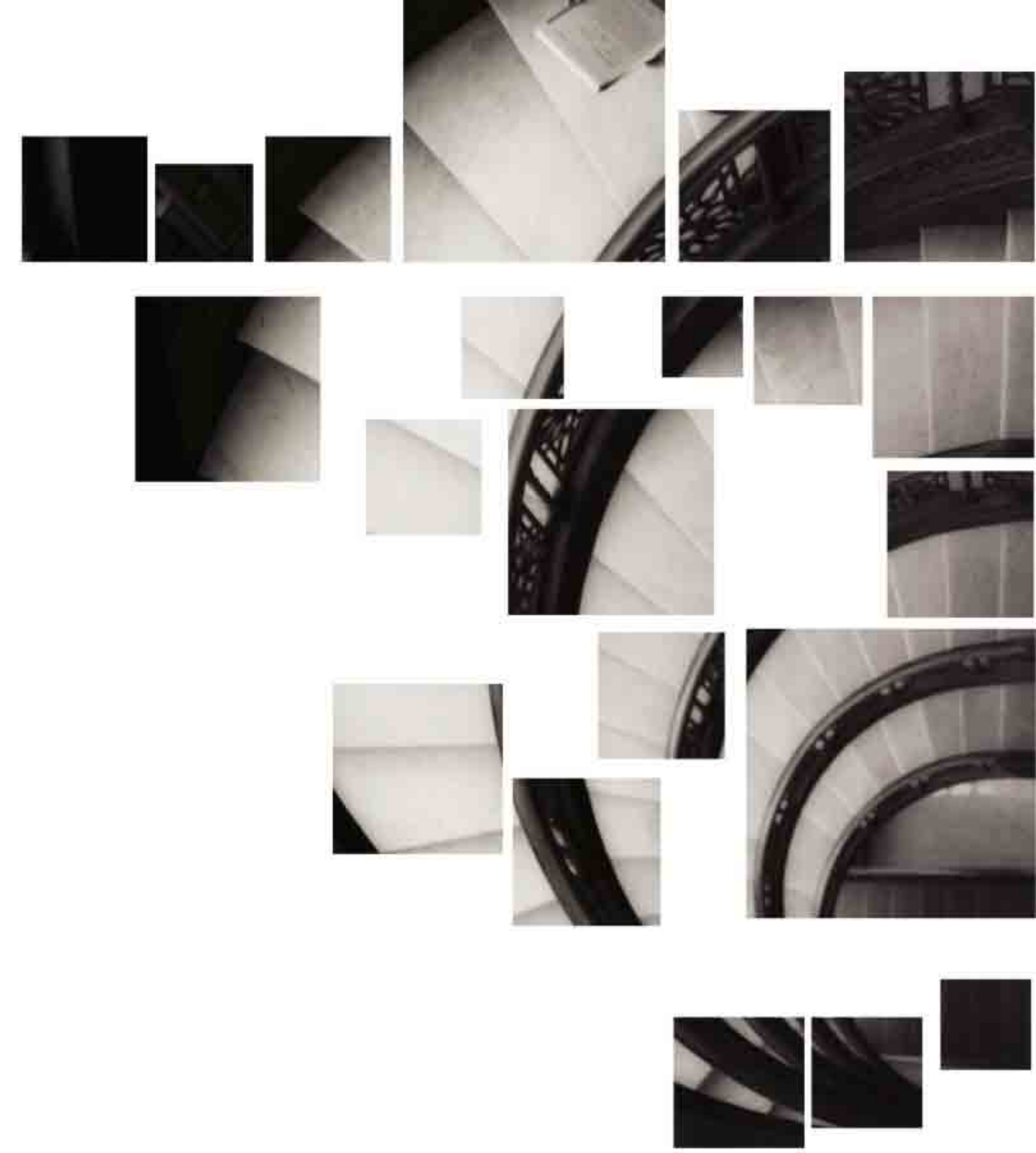

Contents

Company Profile	2
Orbita One Card System Configuration	5
Orbita RFID Access	6
Orbita Split Model	8
Orbita Waterproof Model	10
Lockcase Options and Specifications	14
Lock Installation Diagram	15
Orbita Bathroom Lock	16
Orbita Cabinet Locker	17
Orbita Guest room control system	18
Energy Saving Switch	20
Lift reader&Controller	21
Door Signage	22
Bedside Console & touch screen panels	23
Orbita Hotel Room Safe	24
Orbita Hotel Minibar	26
Orbita Hotel Telephone	28
Successful References	30

Orbita One Card System Configuration

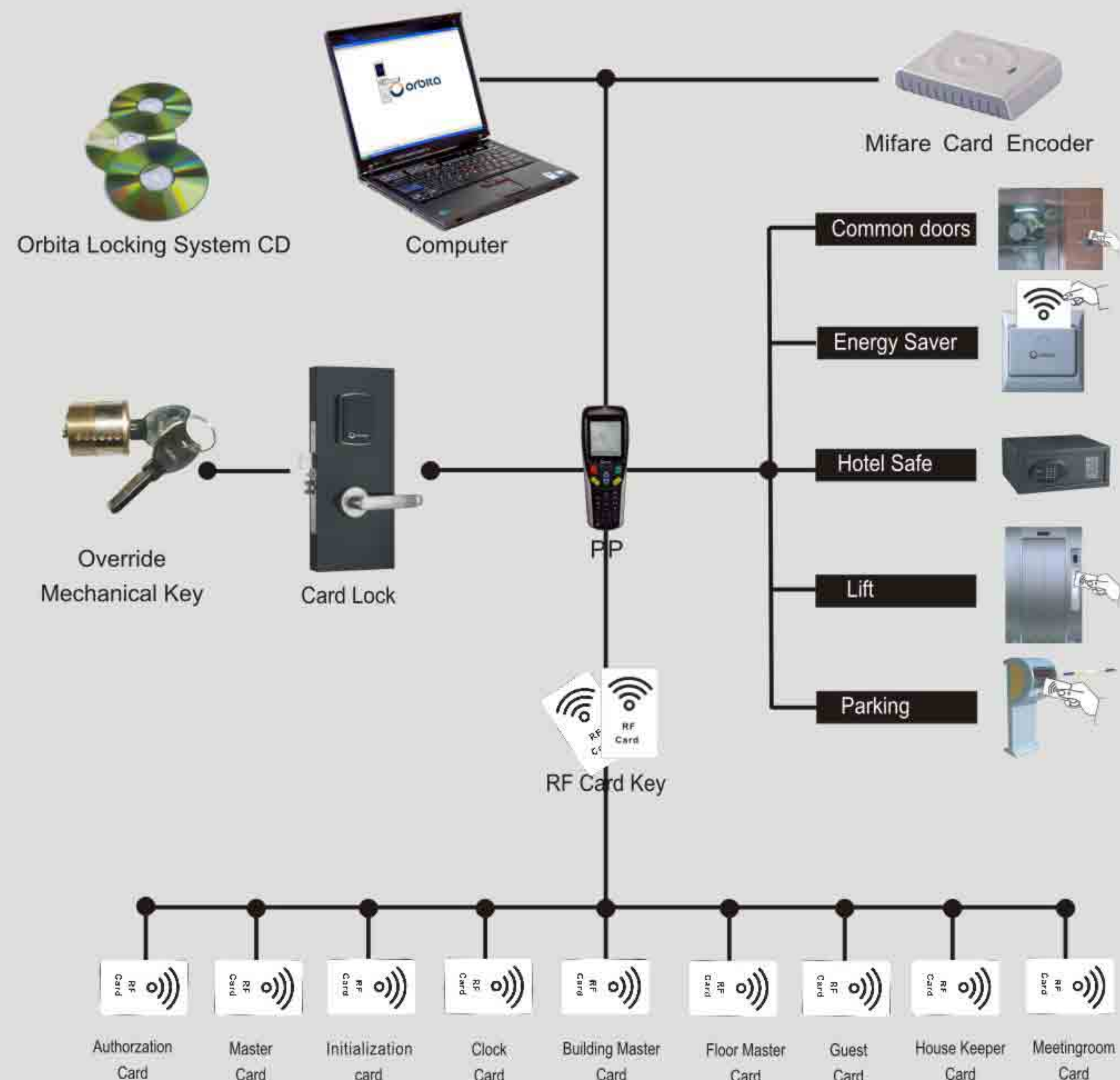

Orbita RFID Access

Fancy Features:

LCD screen showing:

“welcome”, room number, date, time, weekday.

battery status, Wrong operation indication.



TECHNICAL PARAMETERS

Dimension of External Panel:	L285mm*W74.5mm*H13mm
Material:	Stainless Steel, Moisture Proof, Fire Retardant
Working Voltage:	DC6V or 4 AA Alkaline batteries
Power Consumption:	Static Load<10Ua Dynamic Load 100~150Ma
Working Environment:	Working Humidity: 20%~90% Working Temperature: -50℃~60℃
Keycard Option:	Mifare 1 card

FUNCTIONAL CHARACTERISTICS

Interface with most of the PMS systems, Fidelio/Opera registered!

CE & FCC Certified!

Brushed stainless steel color lasts more than 10 years

ANSI Standard mortise

Inside Dead Bolt. Inside handle retracts latches and deadbolt.

Mifare 1K card, compatible with Mifare Energy Saver

Override Computer Key for Emergency use, individual or master cylinder

Lost guest card suspension simply by issuing a new guest card with suspending function

Lock operation record printable: 240 pcs or more

Power: 4pcs #5 AA Alkaline batteries, 18 months' duration

Low battery voltage warning, (Lower than 3.5 V.)

Self Error detecting by LED and “beep”

Improper lock warning

Passage function available

Can be integrated with 16 public areas such as Lift/Parking/Swimming Pool/Sauna Room/Tennis court/Gym ...etc.



Orbita Split Model

Valuable Features:

Sliding reader with hidden cylinder

Elegant, fashionable.



TECHNICAL PARAMETERS

Dimension of External Panel:	L95mm*W62mm*H26.8mm
Material:	Stainless Steel, Moisture Proof, Fire Retardant
Working Voltage:	DC6V or 4 AAA Alkaline batteries
Power Consumption:	Static Load<10Ua Dynamic Load 100~150Ma
Working Environment:	Working Humidity: 20%~90% Working Temperature: -50℃~60℃
Keycard Option:	RF Temic card, Mifare 1 card, Ultra-light card

FUNCTIONAL CHARACTERISTICS

Interface with most of the PMS systems, Fidelio/Opera registered!
CE & FCC Certified!
Stainless steel color lasts more than 10 years
ANSI mortise, European Standard mortise 72mm/85mm hole distance, Anti-panic type is also available
Mortise thickness 18mm, strike thickness 22mm

No electronic inside mortise.

Inside Dead Bolt.
Temic and Mifare card, 100,000 times life, high security, compatible with Energy Saver.
Override Computer Key for Emergency use, individual/master cylinder
Personalized Locking System and cylinder cover
Step by step installation software, easy operation. OEM locking system available.
Classified Access Authorization for safety management.
General master card, building master card, floor master card, guest card, Fire-alarm card
All card with validity, guest card expires automatically at default check out date and time.
Meeting room function and three levels of passage door functions.
Lost guest card suspension simply by issuing a new guest card with suspending function.
Multiple operators with different card issuing authorization
Lock operation record printable. 240 pcs or more
Receptionist card issuing records printable
Power:4 pcs #7 Alkaline battery. 14 months' duration
Low Battery Voltage warning. (Lower than 3.5 V.)
Self Error detecting by LED and "beep".
Improper lock warning
Wireless stand alone lock realizes 95% of on line lock function.
Can be integrated with Lift/Parking/Swimming/Sauna Room/Gym access...etc(One card system)

Orbita Waterproof Model



Valuable Features:

Waterproof design

Complete 304 stainless steel material

Sealed electronics.



TECHNICAL PARAMETERS

Dimension of External Panel:	L290mm*W60mm*H34mm
Material:	Stainless Steel, Moisture Proof, Fire Retardant
Working Voltage:	DC6V or 4 AAA Alkaline batteries
Power Consumption:	Static Load<10Ua Dynamic Load 100~150Ma
Working Environment:	Working Humidity: 20%~90% Working Temperature: -50℃~60℃
Keycard Option:	RF Temic card, Mifare 1 card, Ultra-light card

FUNCTIONAL CHARACTERISTICS

Interface with most of the PMS systems, Fidelio/Opera registered!
 CE & FCC Certified!
 Stainless steel color lasts more than 10 years
 ANSI standard mortise, European Standard mortise 72mm/85mm hole distance
 Inside deadbolt. Inside handle retracts latches and deadbolt
 RF Temic card, Mifare 1 card, Ultra-light card are optional, compatible with its own energy saver
 Override Computer Key for Emergency use, individual or master cylinder
 Personalized locking system and cylinder cover
 Step by step installation software, easy operation. OEM locking system available
 Classified Access Authorization for safety management
 General master card, building master card, floor master card, guest card, Fire-alarm card
 All cards with validity, guest card expires automatically at default check out date and time
 Meeting room function and three levels of passage door functions
 Lost guest card suspension simply by issuing a new guest card with suspending function
 Multiple operators with different card issuing authorizations
 Lock operation record printable: 240 pcs or more
 Receptionist card issuing records printable
 Power: 4pcs #5 AA Alkaline batteries. 18 months' duration
 Low battery voltage warning. (Lower than 3.5 V.)
 Self Error detecting by LED and "beep"
 Improper lock warning
 Wireless stand alone lock realizes 95% of online lock function
 Passage function available
 Can be integrated with 16 public areas such as Lift/Parking/Swimming Pool/Sauna Room/Tennis court/Gym ...etc. That is to say, one Guest card not only can open its own Guest room but also can open other common areas such as Lift, Parking, Club, Swimming...etc optionally (such as if the guest pays for Lift, Parking, Club, Swimming...etc, his Guest card can open its own Guest room and Lift, Parking, Club, Swimming...etc; if not, his Guest card can only open its own Guest room). Also it is suitable for suite Guest room

Lockcase Options and Specifications

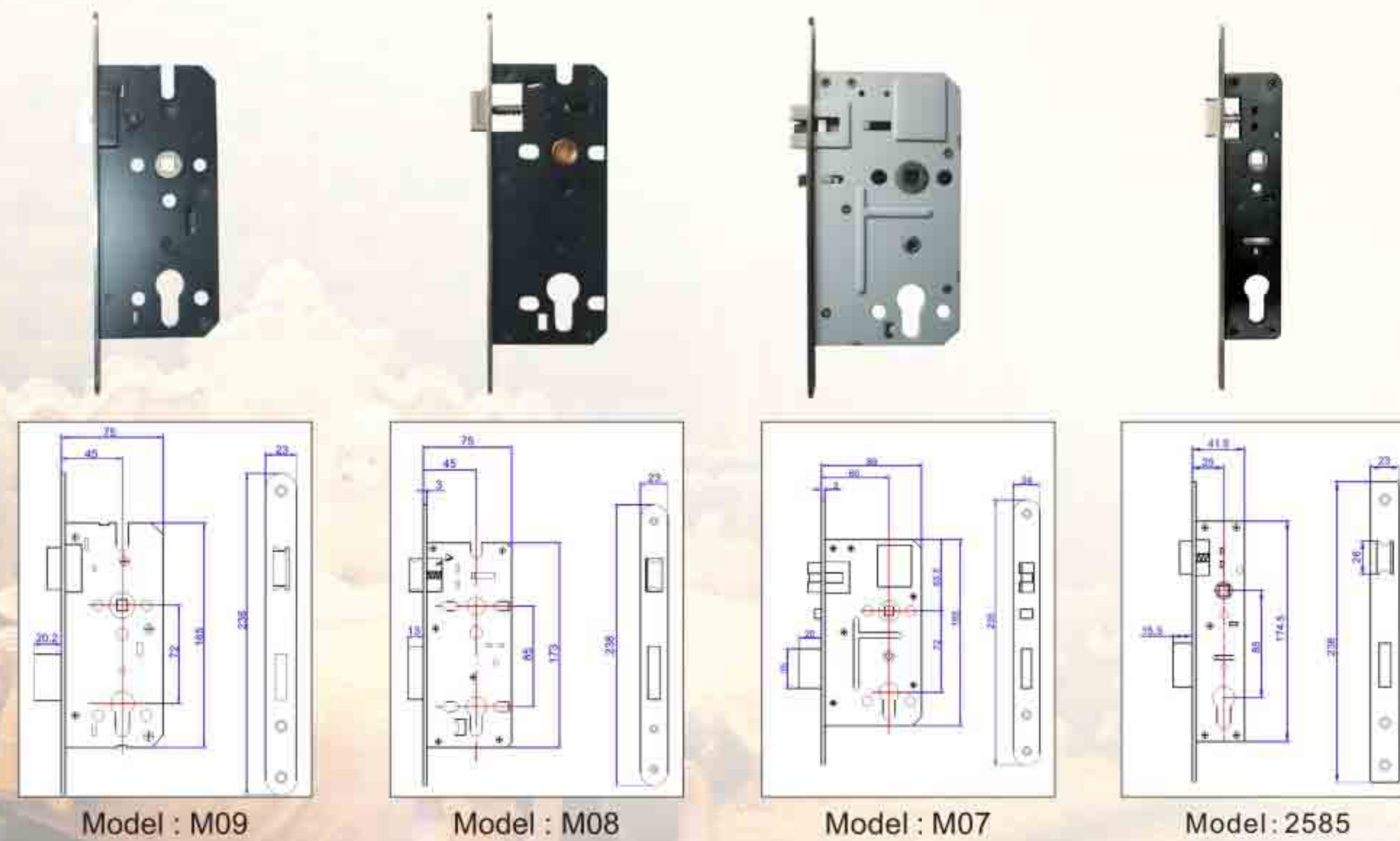
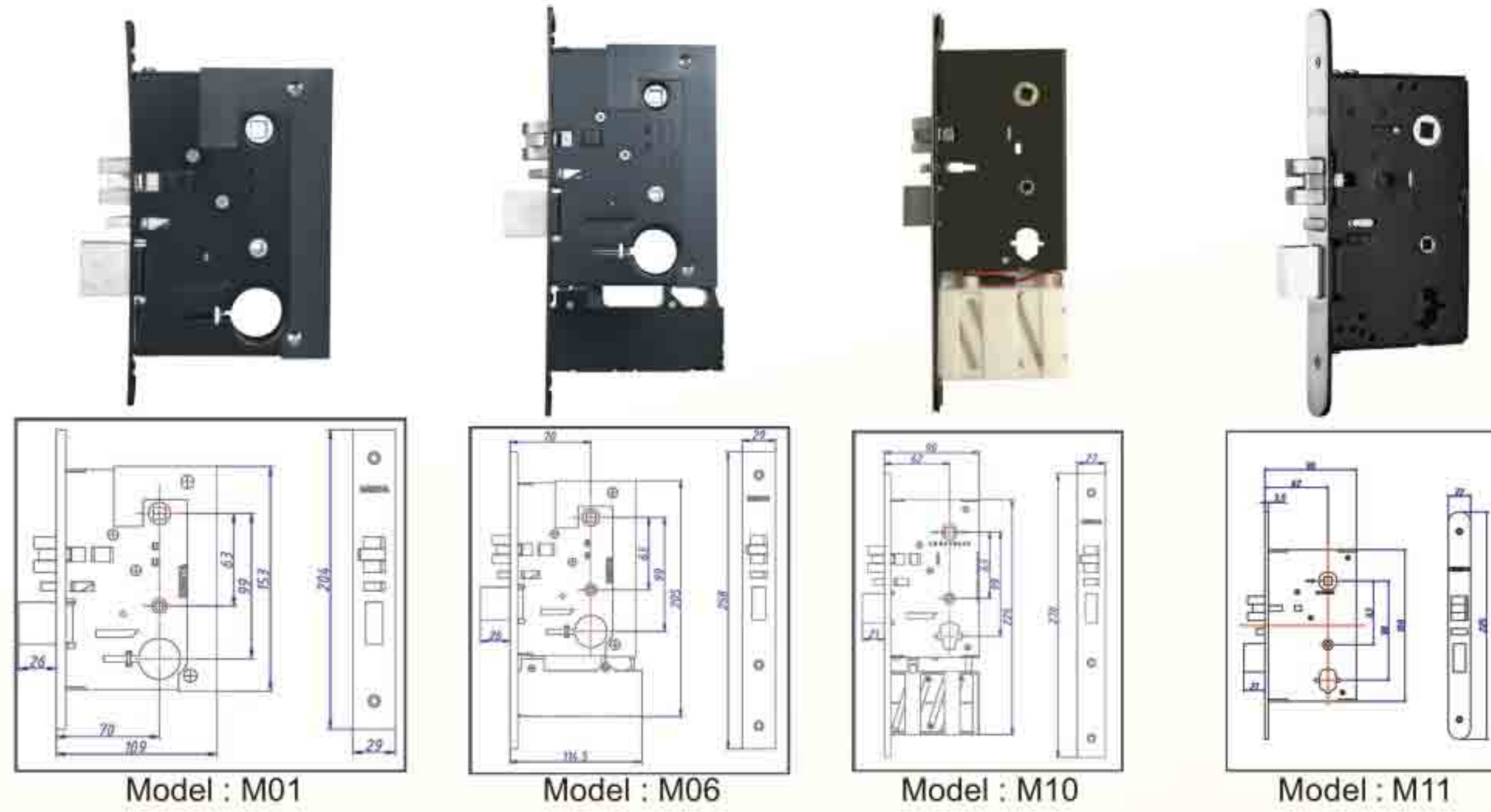

Lock Installation Diagram

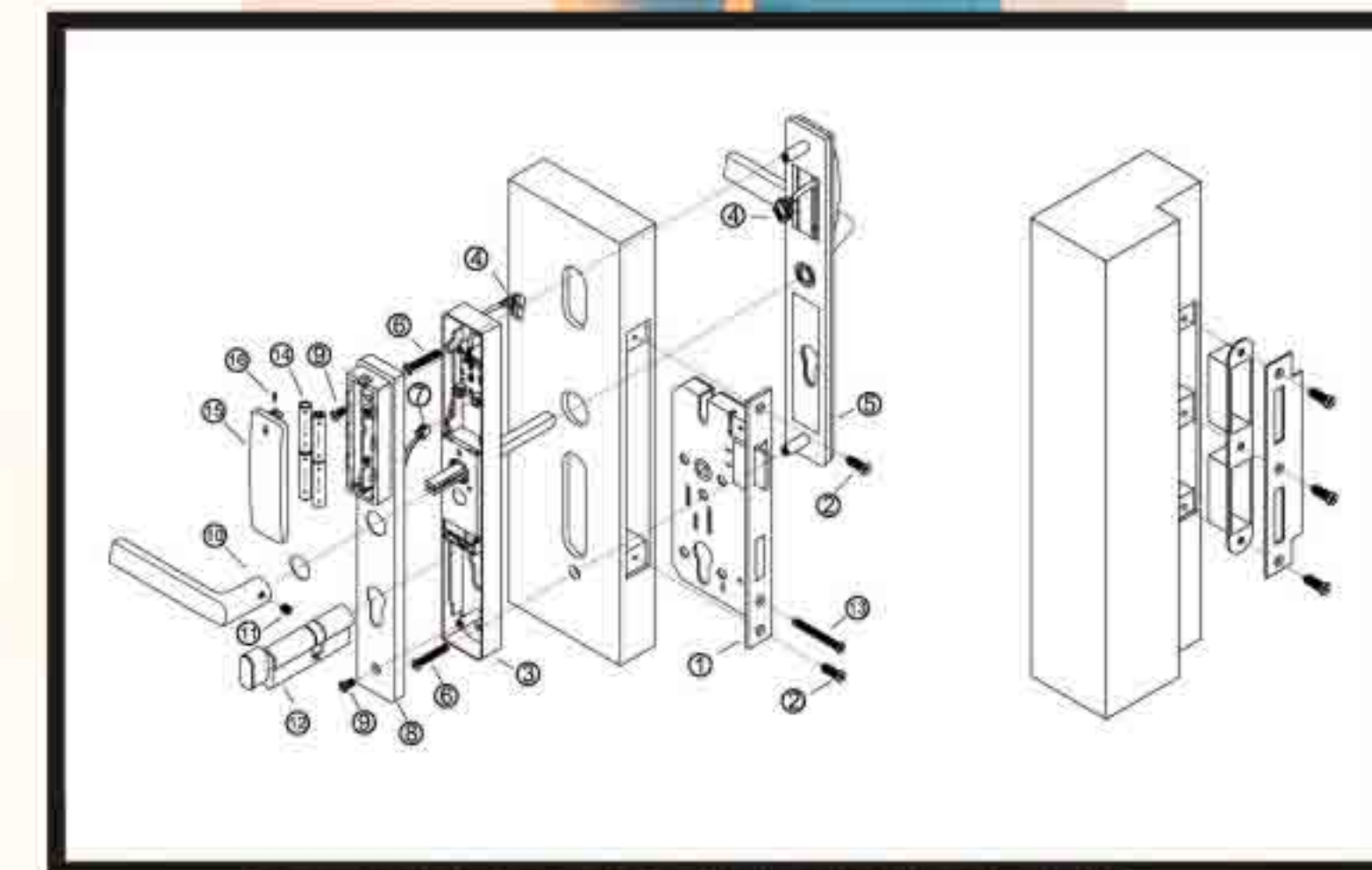
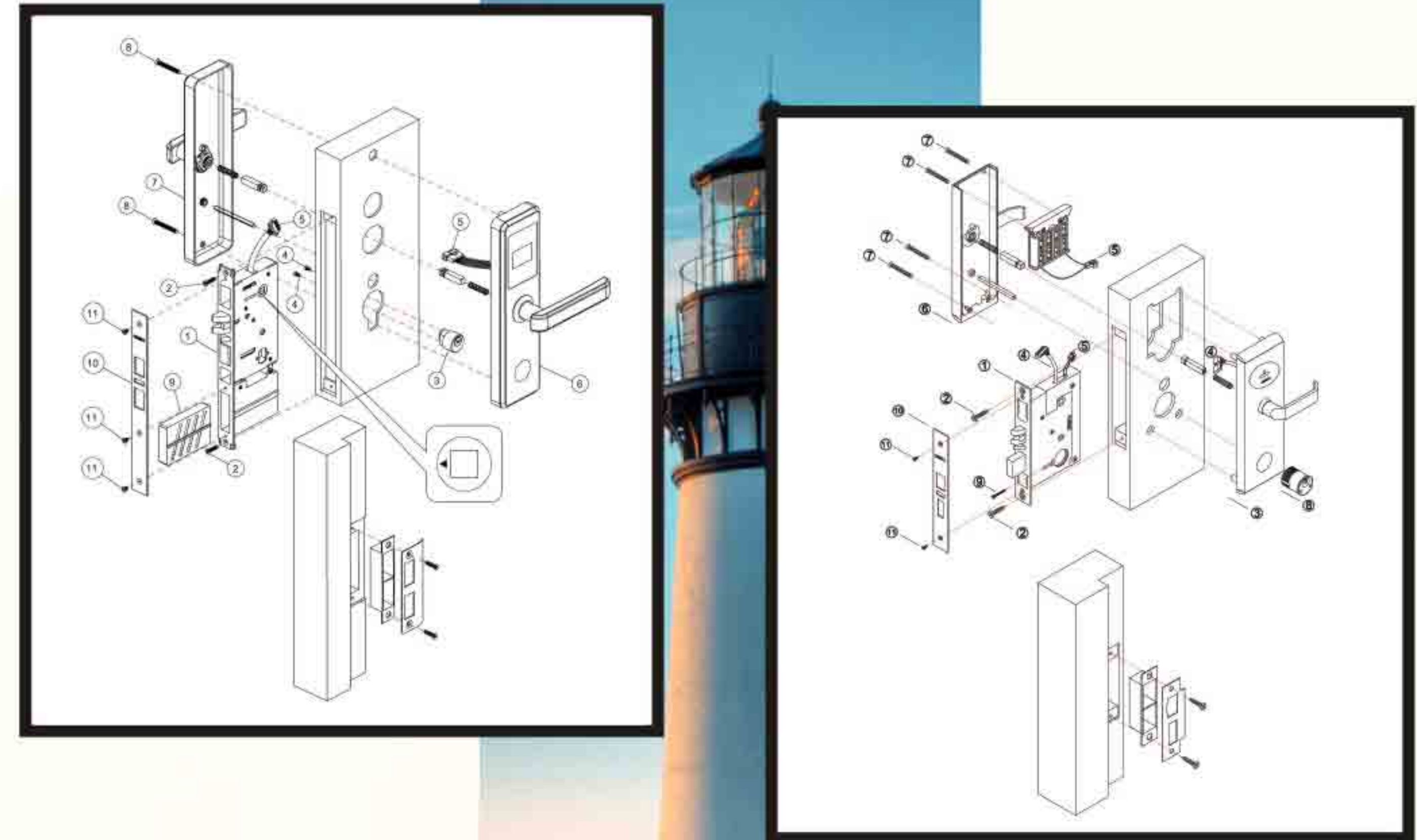

Important Tips:

- Don't use deadbolt as door stopper, this will cause serious problem if deadbolt is damaged or bent.
- Make sure enough space is left for any part of the lock. It is extremely prohibited to hammer in the mortise or the screws. Use a knife, saw or file to fix the hole to make sure the mortise can go inside smoothly. Making sure the spindles or cylinder does not hit any wood.
- Make sure the hole for the latch is deep enough and no burr left inside, when the latch hit the wood or burr, continuous alarming will be activated.
- Adjust and fix the cylinder properly for emergency use.
- Be careful with the cable during installation. Any cable breaking will result in malfunction.
- The deadbolt knob should be upright not horizontal.

Application system diagram

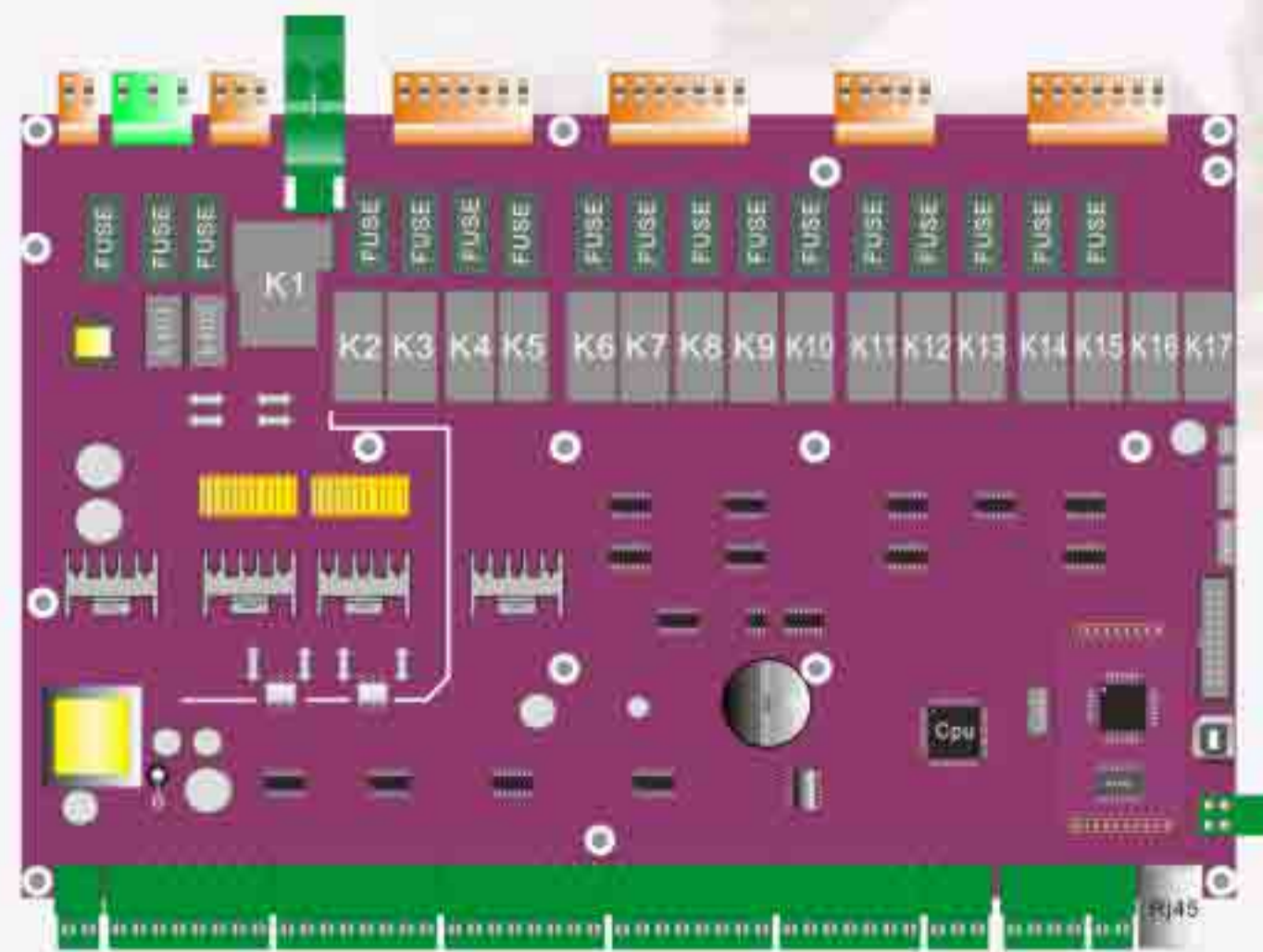

RCU

Lighting control: on/off/dimming/scene
 A/C control: valve/Fan speed
 Curtain control/TV control.
 Door/safe/ window status monitoring.
 Guest/staff in room identification.
 Pc software /app for I pad, mobile phone.

Network diagram

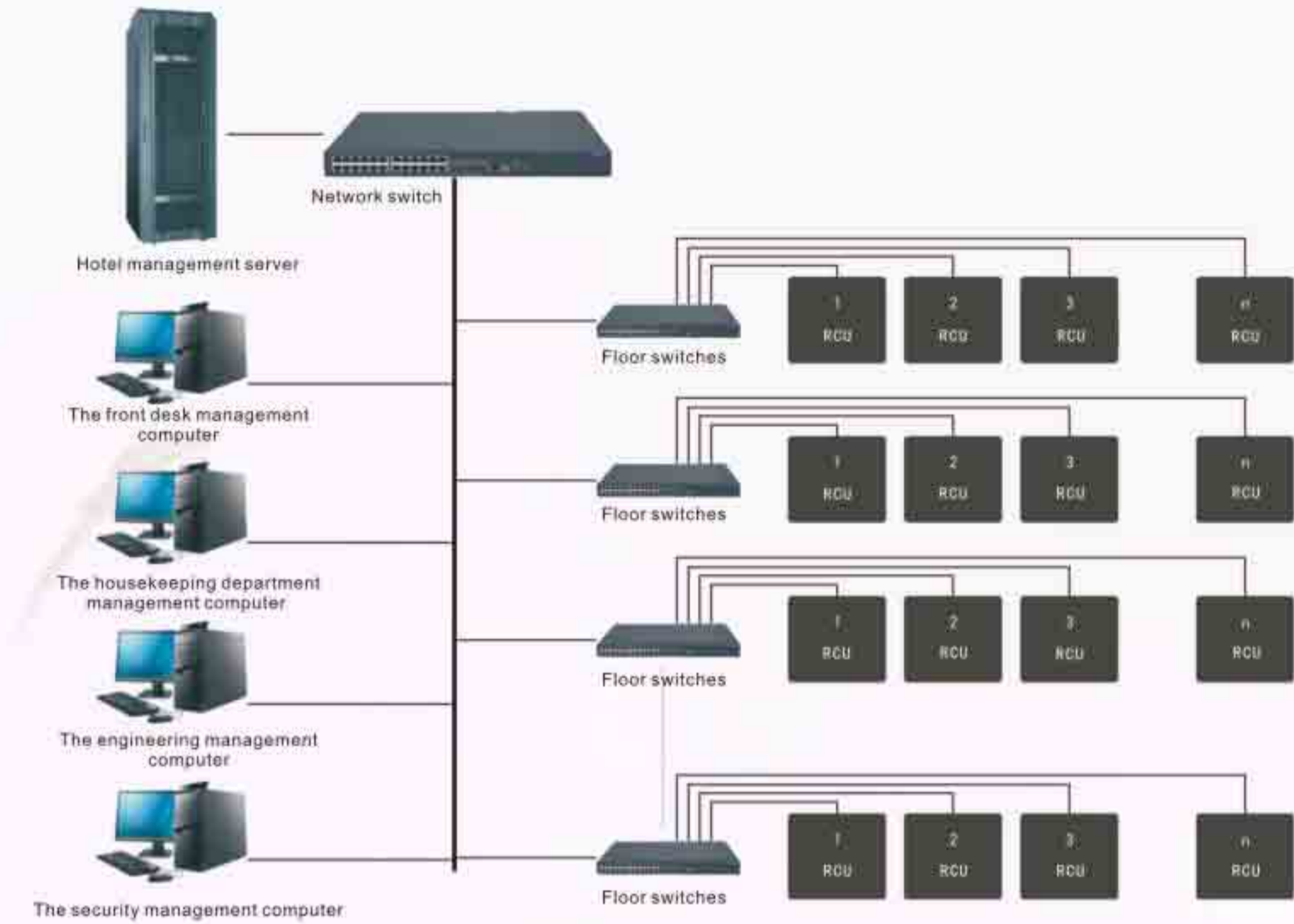

TCP/IP

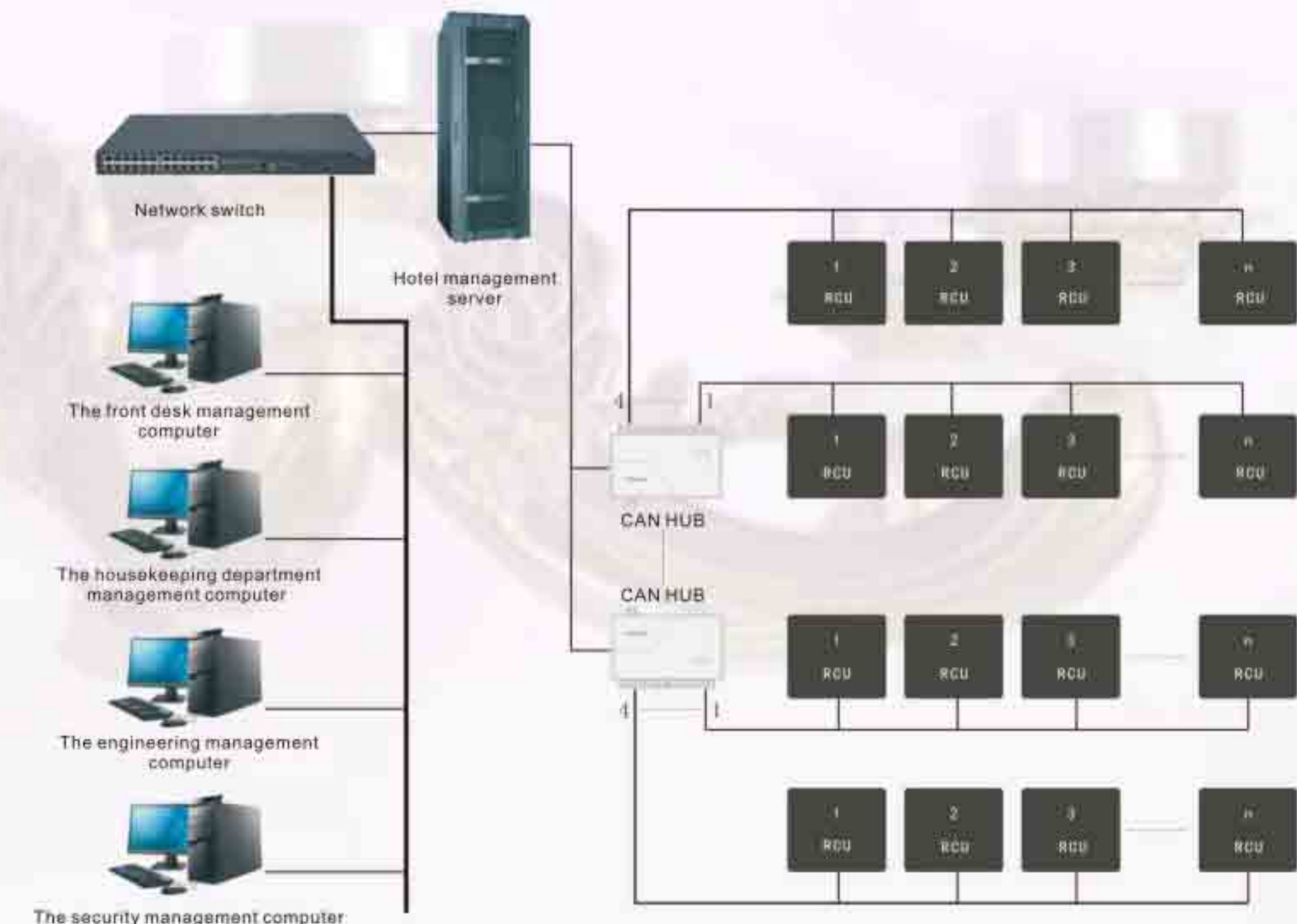

CAN BUS

Energy Saving Switch

Lift reader&Controller

Room only type

Size:86mm×86mm
A/C 220V
Mifare 13.56mhz
Only specific room card can get power
Name card can not get power



ESS-20

Frequency type

Size:86mm×86mm
A/C 220V
Mifare 13.56mhz
Any mifare card can get power
Name card can not get power



ESS-40

3 Phase type

Size:86mm×86mm
DC/12V,120A, 3 Phase output
Guest card get all power
Staff card get limited power
Name card can not get power



ESS-70

Energy saver with don't disturb and make up room

Size:86mm×172MM
A/C 220V or DC 12V
Mifare card/room card/3 phase
Name card can not get power



ESTP-01

Lift reader



MFR-01



MFR-02

Lift controller



MFC-03

FEATURES

- Show guest card , go directly to the guest floor.
- Show staff card , activate all buttons
- No card can not access Public floor
- Emergency or damage, recover lift default function.

Door Signage



DS-358HR



DS-202HS

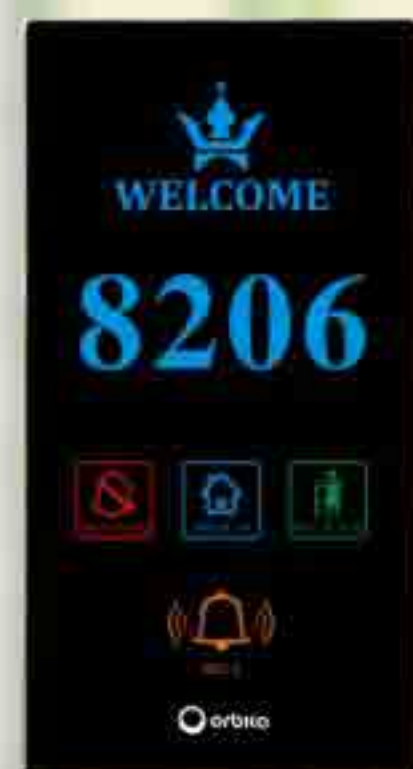

DS-258HR

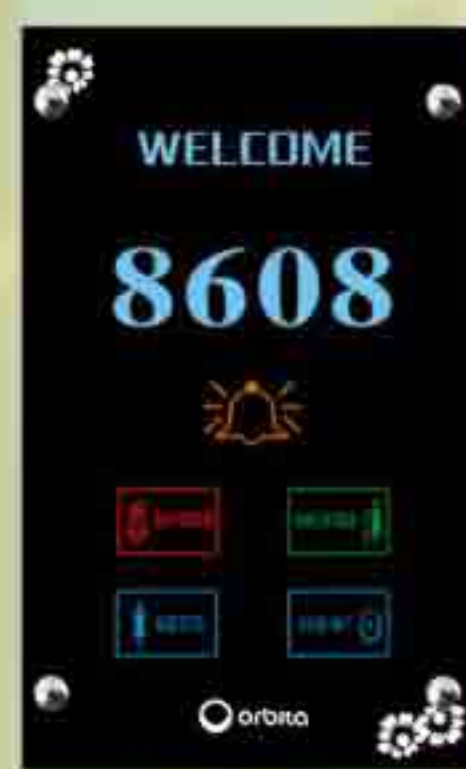

DS-200UP



DS-201HP



DS-201HG



DS-200HS



DS-100S

Bedside Console & touch screen panels

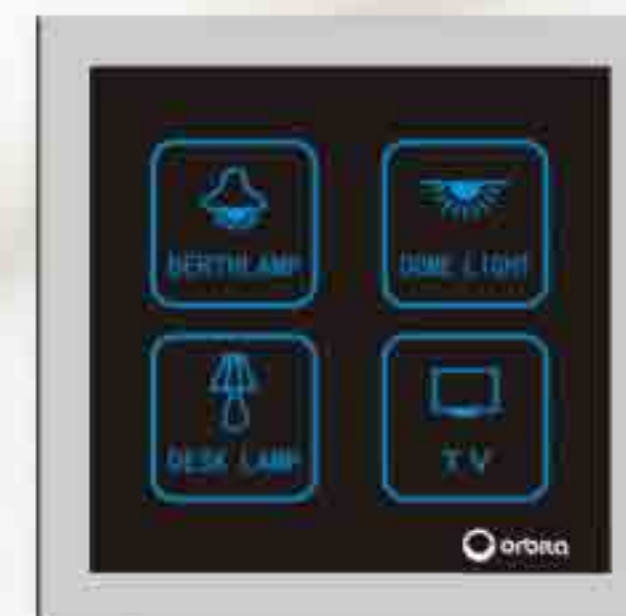

TSS-41S

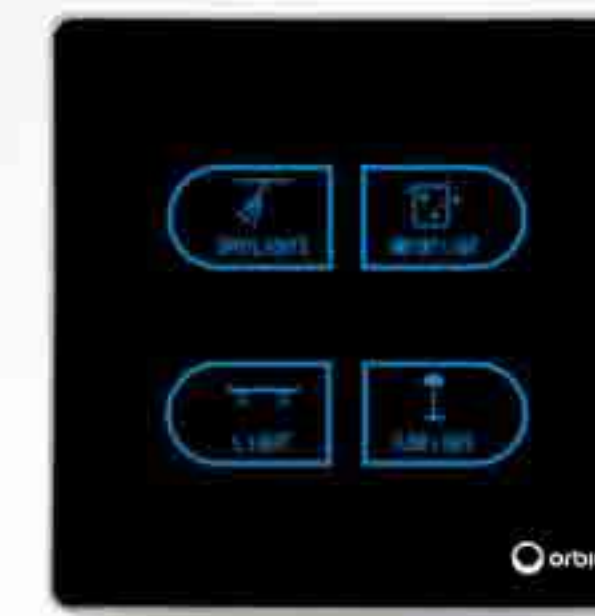

TSS-42S



BC-13B



BC-20B



BC-18G



BC-11G



TSP-01S



TSP-02S

Orbita Hotel Room Safe



OBT-2045MB: H200*L450*D400mm

OBT-2043MB: H200*L430*D370mm

OBT-2040MB: H200*L400*D300mm

OBT-2031MB: H200*L310*D200mm

OBT-2045ME: H200*L450*D400mm

OBT-2043ME: H200*L430*D370mm

OBT-2040ME: H200*L400*D300mm

OBT-2031ME: H200*L310*D200mm

OBT-2045MA: H200*L450*D400mm

OBT-2043MA: H200*L430*D370mm

OBT-2040MA: H200*L400*D300mm

OBT-2031MA: H200*L310*D200mm

OBT-4035CT: H130*L400*D350mm

CONSTRUCTION

5 mm Cold-Rolled Steel Door
Two 3/4 inch (19 mm) Diameter Steel Locking Bolts
Scratch-Resistant Powder Coat Finish

FEATURES

Enhanced LED Display
Audio/Visual Operating Signals
Opening: Two sets of password operation— 4-digit guest password/ 6-digit master password/ 6-CEU password(Optional) and override key
Event audit trail(Optional)
Easy Access Battery Panel
Emergency Battery Jumper Box
Secure Pedestal Mounting
Mechanical Fail-Safe Override Key
Tamper-Proof Installation Hardware
Inner carpet
Spring loaded door
Fixing holes at bottom and back with screws
Auto secure mode (3 times wrong input of code gets frozen for 15mins)

OTHERS

Warranty: 1 year
Batteries: 4AA
Low Battery warning
Batteries included

CONSTRUCTION

5 mm Cold-Rolled Steel Door
Two 3/4 inch (19 mm) Diameter Steel Locking Bolts
Scratch-Resistant Powder Coat Finish

FEATURES

Enhanced LED Display
Audio/Visual Operating Signals
Opening: Two sets of password operation— 4-digit guest password/ 6-digit master password and override key
Easy Access Battery Panel
Emergency Battery Jumper Box
Secure Pedestal Mounting
Mechanical Fail-Safe Override Key
Tamper-Proof Installation Hardware
Inner carpet
Spring loaded door
Fixing holes at bottom and back with screws
Auto secure mode (3 times wrong input of code gets frozen for 15mins)

OTHERS

Warranty: 1 year
Batteries: 4AA
Low Battery warning
Batteries included

CONSTRUCTION

5 mm Cold-Rolled Steel Door
Two 3/4 inch (19 mm) Diameter Steel Locking Bolts
Scratch-Resistant Powder Coat Finish

FEATURES

Enhanced LED Display
Audio/Visual Operating Signals
Opening: Two sets of password operation/4-digit guest password / 6-digit master password and override key
Easy Access Battery Panel
Emergency Battery Jumper Box
Secure Pedestal Mounting
Mechanical Fail-Safe Override Key
Tamper-Proof Installation Hardware
Inner carpet
Spring loaded door
Fixing holes at bottom and back with screws
Auto secure mode (3 times wrong input of code gets frozen for 15mins)

OTHERS

Warranty: 1 year
Batteries: 4AA
Low Battery warning
Batteries included

Orbita Hotel Minibar



MB-30X



MB-30DX



MB-40BB



MB-40GB



MB-60BA



MB-60GA

Model	MB-25	MB-30	MB-40	MB-60
Cooling Method:	absorption	absorption	absorption	absorption
Storage Temperature(°C):	0~12	0~12	0~12	0~12
Input Power(W):	65	65	65	85
Energy Consumption(kwh/24h):	0.9	0.9	0.9	1.2
Validity Capacity(L):	25	30	40	60
Voltage(V):	AC220	AC220	AC220	AC220
Type of Controller	Digital	Digital	Digital	Digital
Type Of Door Seal:	Removable	Removable	Removable	Removable
Net/Gross Weight(kg):	16/18	16.5/18.5	18.5/20.5	21/21.5
Shape Size(W*D*H)mm:	380*400*480	400*420*517	400*470*517	482*480*521
Packing Size (W*D*H) mm:	460*480*545	460*450*560	460*500*560	530*510*600

Outstanding features:

Cool&quiet

High performance with superior absorption new technology
Cooling by ammonia, no moving part, no compressor, no fan
No vibration, no noise (0 db) maintenance-free & long life.

Orbita Hotel Telephone



HT-1001

Professionally designed panel with hotel name and logo printed available.
One-touch button(+10, +5, +3, +0)
14 digits memory
Dual tones electronic ringing and volume 2 levels adjustable
Auto re-dial
Dest and wall mountable.
Thunder-proof and Anti_EMI design.
Waterproof and moisture proof.



HT-1009

Professionally designed panel with hotel name and logo printed available.
One-touch button(+10, +5, +3, +0)
14 digits memory
Dual tones electronic ringing
Auto re-dial
Dest and wall mountable.
Thunder-proof and Anti_EMI design.
Waterproof and moisture proof.



HT-1003

Professionally designed panel with hotel name and logo printed available.
One-touch button(+10, +5, +3, +0)
Large message light, voice message extraction
Dual tones electronic ringing and volume 2 levels adjustable
Storage key-memory function
Auto re-dial
Dest and wall mountable.
Thunder-proof and Anti_EMI design.
Waterproof and moisture proof.



HT-1009B

Professionally designed panel with hotel name and logo printed available.
One-touch button(+10, +5, +3, +0)
Large message light, voice message extraction
Dual tones electronic ringing
Take-up automatically
Auto re-dial
Dest and wall mountable.
Thunder-proof and Anti_EMI design.
Waterproof and moisture proof.



HT-1005

Professionally designed panel with hotel name and logo printed available.
One-touch button(+10, +5, +3, +0)
14 digits memory
Dual tones electronic ringing
Speaker volume Hi/Low adjustable.
Dest and wall mountable.
Thunder-proof and Anti_EMI design.
Waterproof and moisture proof.



HT-1010

Professionally designed panel with hotel name and logo printed available.
One-touch button(+10, +5, +3, +0)
14 digits memory
Dual tones electronic ringing and volume 2 levels adjustable
Auto re-dial
Dest and wall mountable.
Thunder-proof and Anti_EMI design.
Waterproof and moisture proof.



HT-1006

Professionally designed panel with hotel name and logo printed available.
One-touch button(+10, +5, +3, +0)
16 digits numbers LCD display
Storage, Set up
Auto re-dial
Dest and wall mountable.
Thunder-proof and Anti_EMI design.
Waterproof and moisture proof.



HT-1011

International fashion design appearance.
Human engineering mechanics project of handle
Soft humanized ring
Beautiful and efficient useful ring-coming light.
Double audio dialing
Automatic redial
High immunity to electro-magnetic radiation
Waterproof and moisture proof.



HT-1008

Professionally designed panel with hotel name and logo printed available.
One-touch button(+10, +5, +3, +0)
14 digits memory
Dual tones electronic ringing
Ringer indicate light
Dest and wall mountable.
Thunder-proof and Anti_EMI design.
Waterproof and moisture proof.



HT-1012

International fashion design appearance.
Human engineering mechanics project of handle
Soft humanized ring
SOS emergency call key
Automatic redial
Dest and wall mountable.
High immunity to electro-magnetic radiation
Waterproof and moisture proof.

Successful References



Saint regis moscow (previous kempinski moscow)



warwick hotel, doha



Hilton-hotel-kampala, Uganda



Leo Meridian Resorts, India



Kinta Riverfront Hotel & Suites
Ipoh • Malaysia



Ramada Hotel, Pakistan



Radisson Blu Hotel, Zambia



Nilai Springs Resort, Malaysia



Atlantica caldera palace, Greece



novotel-phuket-kamala-beach-front



Sphinx Resort, Egypt



Oscar group Resort, North cyprus



Grand Hotel Reykjavik, Iceland



Kenya Bay Beach Hotel



Hawler Plaza Hotel, Iraq



Crown Regency Hotels & Towers in Cebu, Ph



Best Western Plus in MD, USA



Aswan Hotel, Egypt



Twin Plaza Hotel, Indonesia



Imperial Hotel, Turkey



Duc Long Hotel, Vietnam



Asia Paradise Hotel, Vietnam



Mercure Value Hotel, Saudi Arabia



Corp Hotel, Dubai



Erbil International Hotel, Iraq



King Solomon Hotel, Israel



Intercontinental hotel, Ethiopia



Ginger Hotels, India



GK International Airport Hotel, Benin



Caldera Palace, Greece



Reikartz Hotels & Resorts, Ukraine



Days Inn Deccan Plaza, India



Crown regency prince resort in Boracay, Ph