



CISA eSIGNO

Contactless Lock

Automatic Deadbolt DPR
EURO Version

Technical Sheet



Configuration options - 4 finishes, 3 handle types and 2 cover colours



Satin silver
Black plate



Polished silver
Black plate



Satin bronze
Black plate



Polished gold
Black plate



Classic handle



Modern handle
Return to door EN 179



Elegance handle



Black plate



White plate

Installation

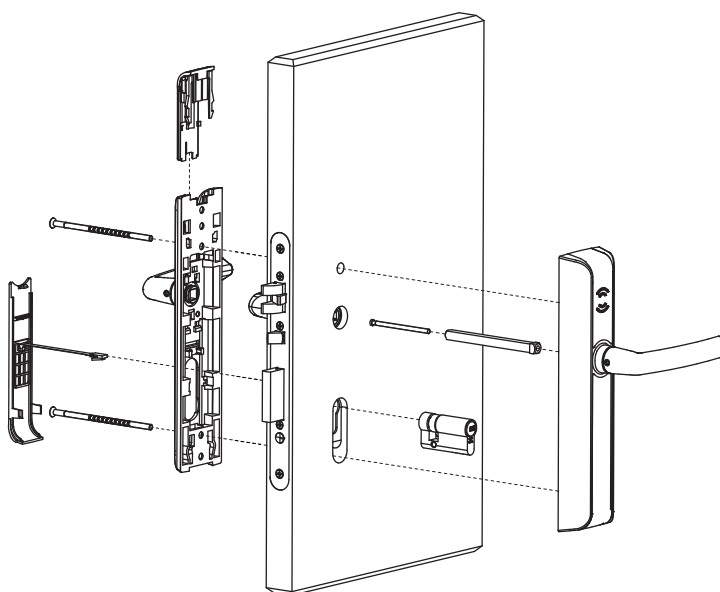

Technical drawings:
all measurements are in mm.

Handle plate

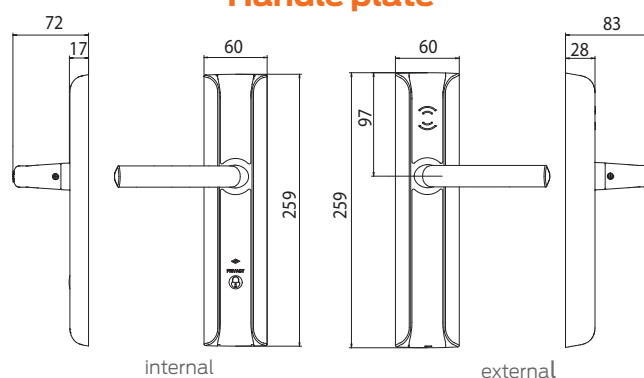

5A504, 5A514 lock series – Strike plate

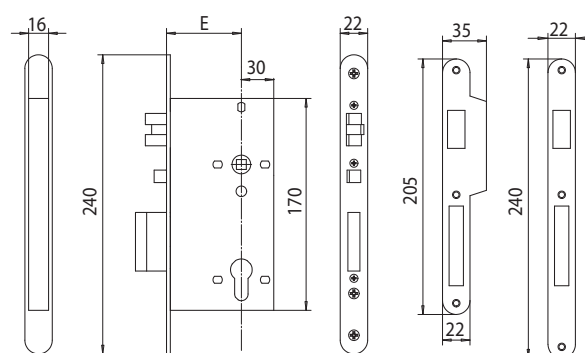

Technical features

Intended use	Standalone battery powered contactless electronic access control for door installation.
Form factor	Reader and battery holder integrated into the external plate. Only 2 screws needed for installation.
Retrofit	Footprint designed to simplify retrofit installation. Retrofit underplate also available (386x72 mm).
Credentials	Contactless RFD ISO 14443B/Mifare ISO 14443A, NFC ready. Lock wake-up function activated by card from max 2 cm.
Operating temperature	From -10°C to 70°C (with specific batteries).
Data encryption	3DES-AES encryption.
Audit trail	Previous 500 events.
Privacy	Digital privacy function activated by a push button located on the internal plate. Available with autodeadbolt mortise lock series 5A504, 5A514.
Emergency override detection	Mechanical emergency opening detection and tracking.
Wireless	System also available in wireless version (2.4 GHz Zigbee technology). Locks can communicate with the centralised control system through a wireless network. Easy to reprogramme/delete cards.
Door ajar detection	Door left open reported via the wireless connection.
Flashing signal	Multicolor LED on external plate for battery level, privacy status and service messages. Internal LED for privacy status.
Battery	3 x 1,5V AAA alkaline.
Durability	30.000 cycles approx for standalone version (depending on operating conditions).
External plate	L 259 x H 28 x W 60 mm
Internal plate	L 259 x H 18 x W 60 mm
Weight	Packed: 2 kg (including external and internal plates, handles, batteries).
Material	External/Internal plates in Zamak 3 (ZP3 in compliance with UN EN 12844).
Plastic	PA6 / PA12. Cover plate available in black or white version.
Finishes	Satin Silver / Polished Silver / Satin Bronze / Polished Gold.
Handles	Classic / Modern Return to door / Elegance (only available in Polished Gold).
Spindle size	8 mm
Center	85 mm if 5A504/5A514 lock is used.
Mechanical emergency cylinder	Euro Profile half cylinder concealed under plastic cover. Accessible using tool supplied with the Service Kit.
Standard mechanical lock	Autodeadbolt mortise lock series 5A504, 5A514 with antipanic function and DPR (Door Position Report). Backset 60 – 70 – 80 – 90.
Door thickness	35 - 79 mm
Application	Indoor
Life cycle	200.000 cycles.
Installation	Compatible with electric screwdrivers i.e. high torque.
Norms and regulations	Compatible with products in compliance with standard EN1634-1 (for fire resistant doors up to 60 minutes), EN179, EN12209, UL (European standards).
Management system	Wave Mode encoder, communication with locks through NFC mouse or service cards.

About Allegion

Allegion (NYSE:ALLE) creates peace of mind by pioneering safety and security. As a \$2 billion provider of security solutions for homes and businesses, Allegion employs more than 8,000 and sells products in more than 120 countries across the world. Allegion comprises 27 global brands, including strategic brand CISA®, Interflex® LCN®, Schlage® and Von Duprin®.

For more, visit allegion.com

 **BRICARD** ■ **Briton** ■  **CISA** ■  **interflex**

CISA S.p.A.
Via Oberdan, 42
48018 Faenza (RA) Italy
Tel. +39.0546.677111
Fax +39.0546.677150
cisa.vendite@allegion.com
cisa.com
cisahotels.com

@cisalocks

